

# HODOLOGÍAS

Sobradillo. Espacio Life

An artwork by Juanma González

*I hear and I forget,  
I see and I remember,  
I do and I understand.*

CONFUCIUS

*It takes a village  
to raise a child.*

AFRICAN PROVERB



Life Space -----> Represented Space -----> Inherited Space

### Hodologies

The concept of Holodogy was created by reflections of Kurt Lewin, a Gestalt psychologist. He talked about a different space from euclidian space (dominated by geometry), a life space crossed by people, who walk and live in that space according to their necessities, their preferences or pure enjoyment of that landscape.

Since the middle of the 21st century, artists have worked on this concept. They claim the significance of walking as an intrinsic part of man, creating spaces and giving sense to their surrounding world. I'm interested in the position of man faced with the inhabited environment.

When we cross a space, it describes how we are. We all have our own path to follow.

### Land Art

More than natural-physical space, Land Art is placed in particular space-time coordinates; they disturb euclidian perception of art work by the spectator, he goes out of space-time (Tonia Raquejo)

According to Javier Maderuelo, this artistic discipline combines: place, situation, atmospheric state, artist, and all the things that happen there. Art cannot be limited to its 'objectual' character. Earth as reference, nature has a space not only as representation but also as experiment.

Look towards the past. The itinerary as essential part of the artwork. The achievements of science, progress toward a hypothetical better future, a critical gaze revising our current times and the concept of culture and development.

### Sobradillo

Location: 40°55'01"N 6°47'58"O

Country: España  
Autonomous Community: Castilla y León  
Province: Salamanca  
Region: El Abadengo  
Main town: Vitigudino  
Mancommunity: El Abadengo

Area: 53,50 km²  
Population: 266 hab. (2012)  
Population Density: 4,97 hab./km²  
Altitude: 651 msnm

The roots of Sobradillo go back to 3000 B.C, during the Neolithic period. There are dolmens similar to the megalitic monuments in Zamora, Burgos and Ávila regions. In a village 25 kilometers away, Siega Verde, there is the most important outdoor Paleolithic art in all of Castilla y León.

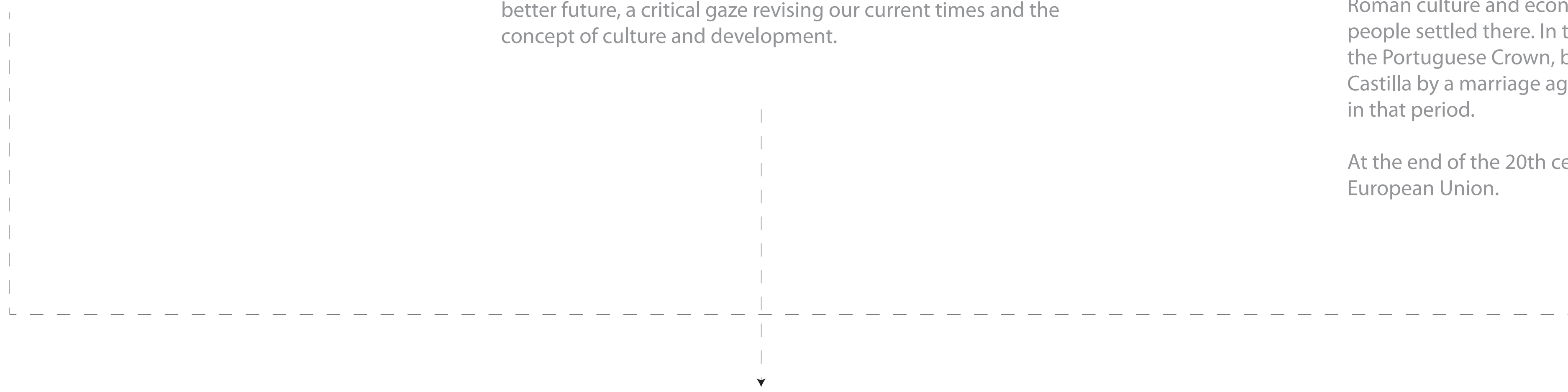

Also there are Vettones settlements (450 B.C) that adopted the Roman culture and economy from 1st century, when Christian people settled there. In the 13th century, the village belonged to the Portuguese Crown, but in the next century it become part of Castilla by a marriage agreement. There was a Jewish settlement in that period.

At the end of the 20th century, Sobradillo became part of the European Union.

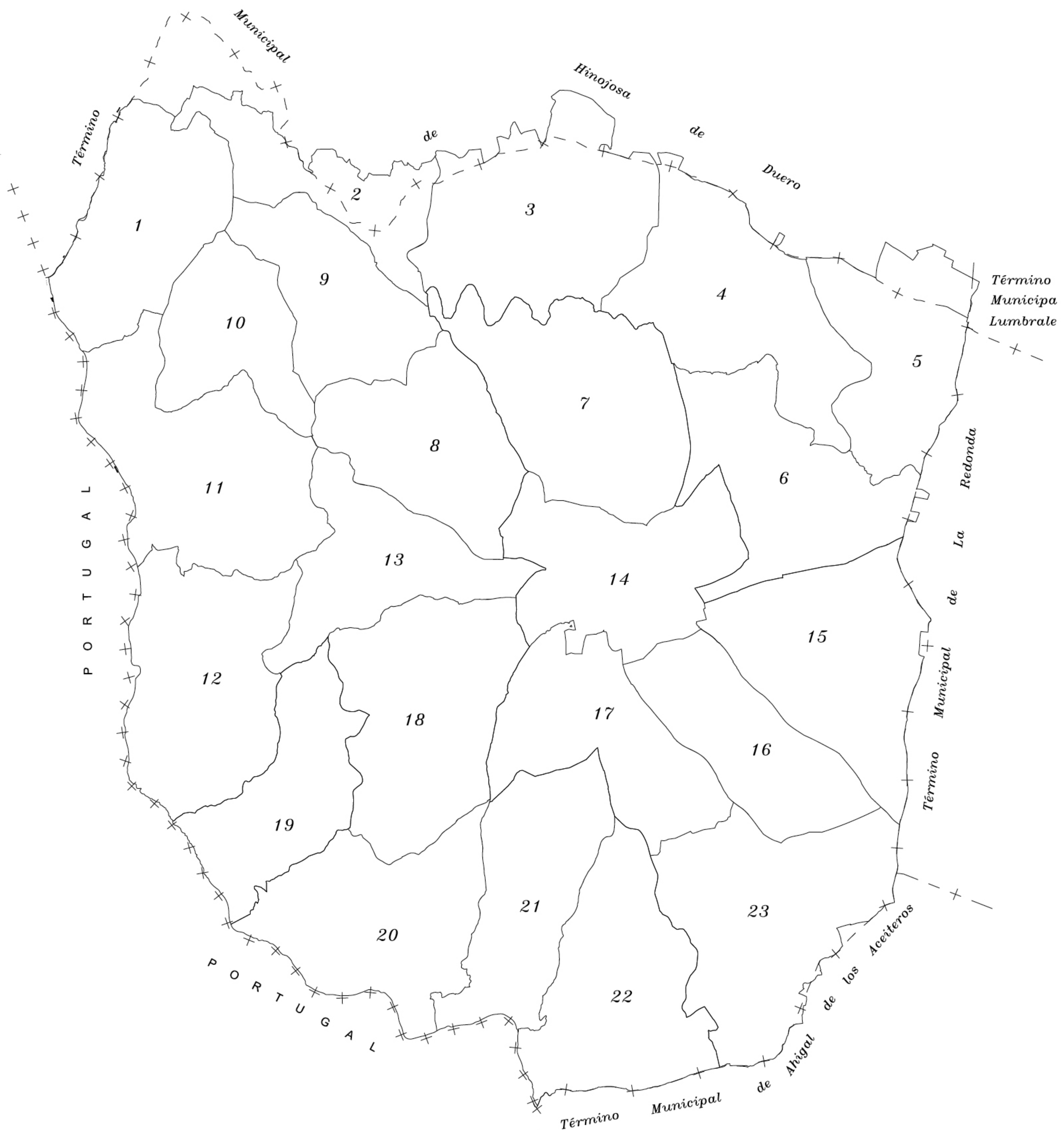

*return to origin*



 <b>Junta de Castilla y León</b> Consejería de Agricultura y Ganadería Dirección General de Producción Agropecuaria y Desarrollo Rural		 <b>INSTITUTO TECNOLÓGICO AGRARIO</b> Junta de Castilla y León Dirección de Agricultura y Ganadería	
ZONA DE CONCENTRACIÓN PARCELARIA:			
<b>SOBRADILLO</b>			
PROVINCIA: SALAMANCA			
FASE:		<b>PROYECTO</b>	
Observaciones:		<b>DISTRIBUCIÓN DE POLIGONOS</b>	
		 Plano nº1: <b>0</b>	
		Escala: S/E	
		Fecha:	





 	
Junta de Castilla y León Consejería de Agricultura y Ganadería Dirección General de Producción Agropecuaria y Desarrollo Rural	
INSTITUTO TECNOLÓGICO AGRARIO Junta de Castilla y León Dirección de Agricultura y Ganadería	
<b>ZONA DE CONCENTRACIÓN PARCELARIA:</b> <b>SOBRADILLO</b>	
PROVINCIA: SALAMANCA	
FASE: <b>PROYECTO DE CONCENTRACIÓN</b>	
Observaciones: <b>PLANO GENERAL</b>	
	
Plano nº: <b>00</b>	
Escala: 1/10.000 ISO A0	
Fecha: Diciembre 2011	



Pol	Parc	Prop	1°	2°	3°	4°	5°	6°	7°	8°	9°	10°	Sup.To
1	21	317							1010	5773	8175		14958
4	202	145							960	1332			2292
5	186	145	2646		1532				5380	8087	7685	598	25938
9	28	317			765	2470	632	600	1398	3871	5929		15665
9	95	317			2173				853	3488	2012	874	9400
9	1375	145					1569		1872	2089			5530
10	252	145			1753	787	235						2775
10	283	145					883	3456	2560	4797	4273	83	16052
10	286	317						1173	2281	6596	3166		13216
11	225	317				1055		1473	798				3326
14	155	145				817	601	2103	481	809	2951		7762
15	241	145		2851									2851
15	280	145						1358	1852	2640			5850
15	288	145						640	1129				1769
19	13	145							6244	5208	833	1413	13698
19	323	145					9	165	177	199	1917	662	3129
23	839	145				3	2	15	122	428	417	65	1052
24	747	317								59	266	151	476
25	788	317							1612	1304	4788	1700	9494
27	54	145		991	2388	860	3118	4517	3097				14971
27	290	145						2828		3281	1249		7358
29	438	145				772	867	4202	549				6390
29	479	145					3790	4872	2575	590	2471	535	14833
31	173	145			1179	1331	1985	1029					5524
32	11	145						2535					2535
32	80	145			641	1519	2432	1359	6622				12573
33	395	317						1461	1934	2905			6300
34	424	317							10	3872			3882
34	574	317									305		305
34	609	145						1195					1195
35	476	145								3502	13164	322	16988

In 2001, lands were regrouped in Sobradillo, a village located in Las Arribes, west of Salamanca. All family properties of land were joined in big plots. The method of allocation was done according to the criteria of Castilla y León engineers, who rated the land in a scale of 1 to 10.

Several plots have been assigned to my family. An artificially created space is the result of a method that does not bear in mind personal and sentimental values.

It's a life space, it cannot be limited to numbers and empirical values. The land properties of my family are the result of work during a lot of generations.

*to breathe*  
*to cry*  
*to eat*  
*to feel*  
*to find*  
*to graze*  
*to harvest*  
*to ignite*  
*to irrigate*  
*to laugh*  
*to limit*  
*to pick up*  
*to prune*  
*to push*  
*to recreate*  
*to sleep*  
*to snore*  
*to sow*  
*to stack land*  
*to sweat*  
*to touch*  
*to transport*  
*to walk*

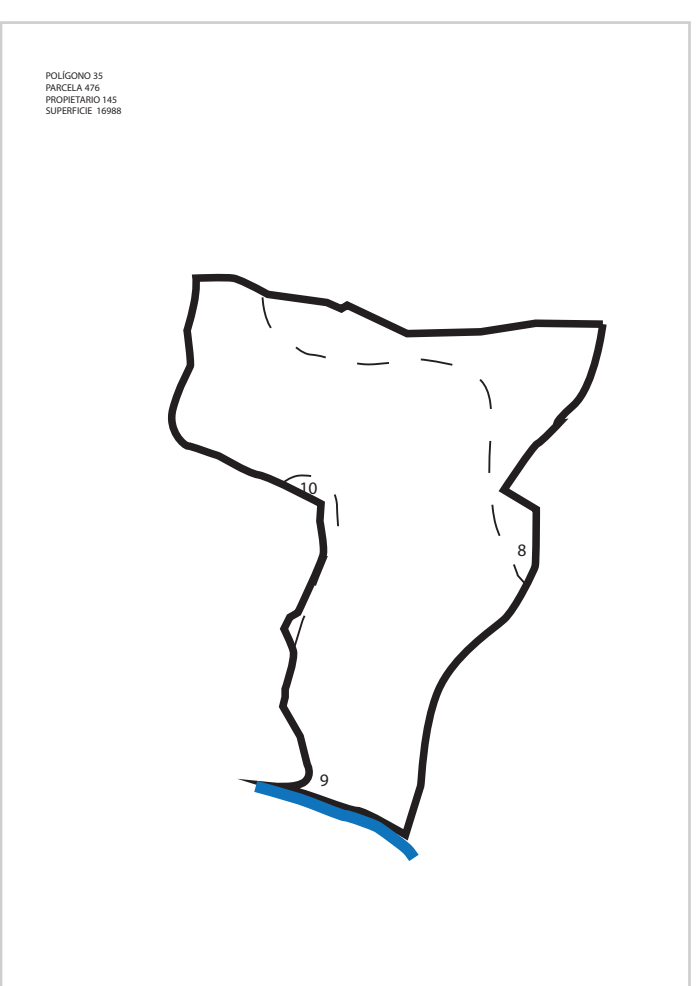
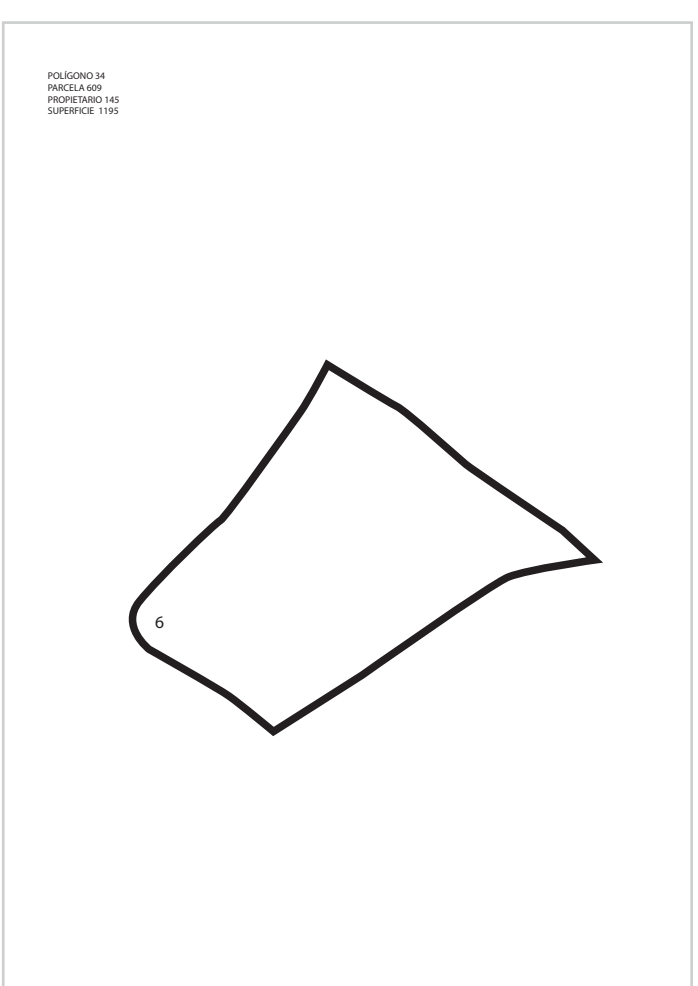
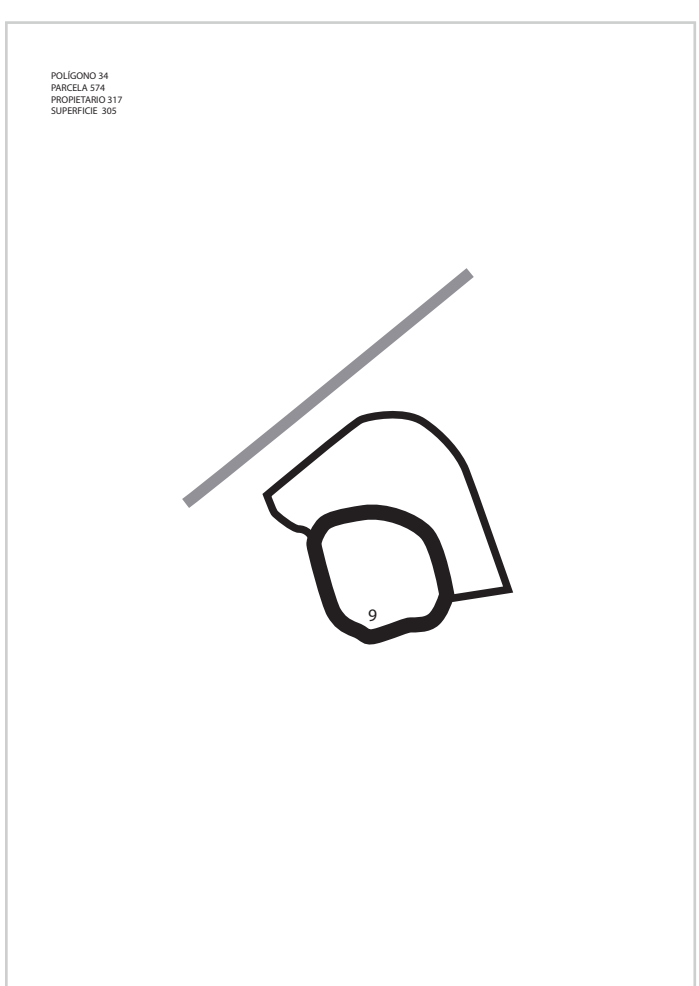
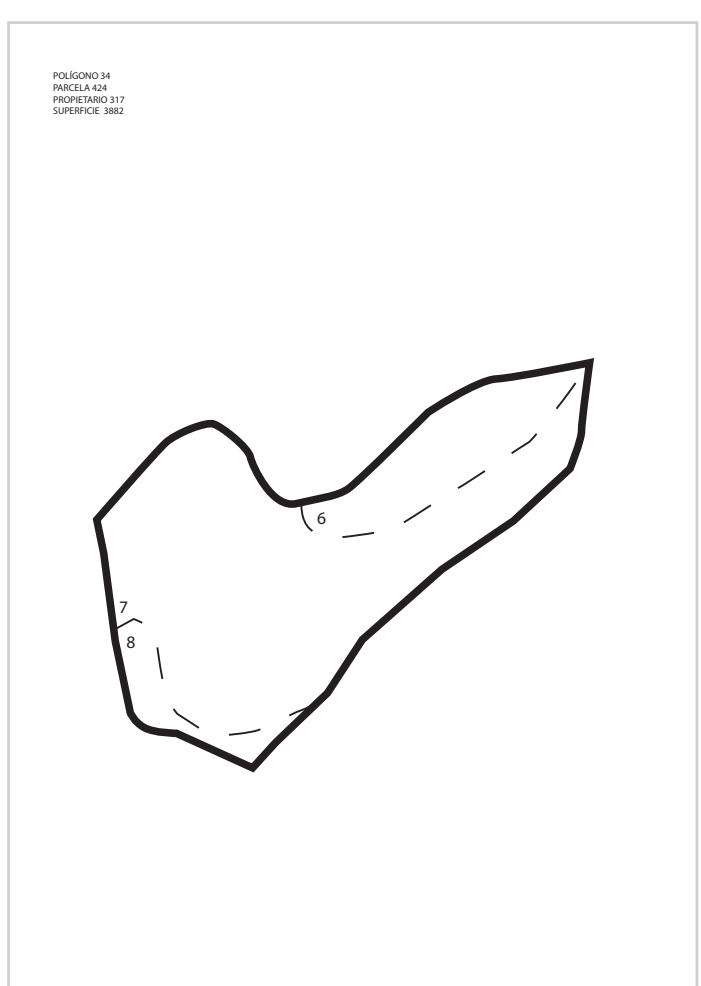
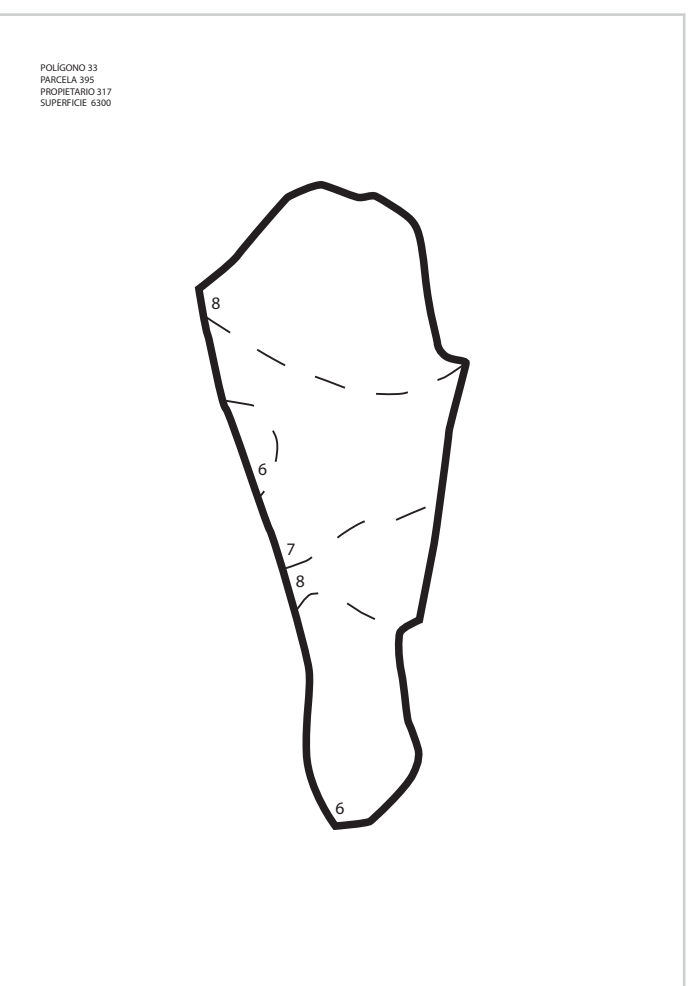
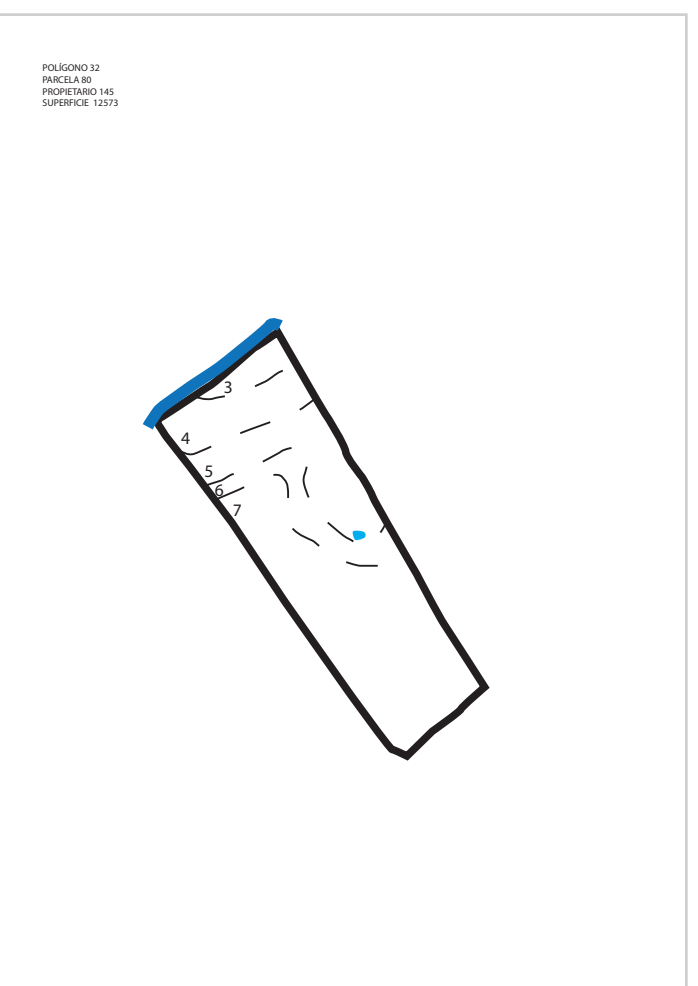
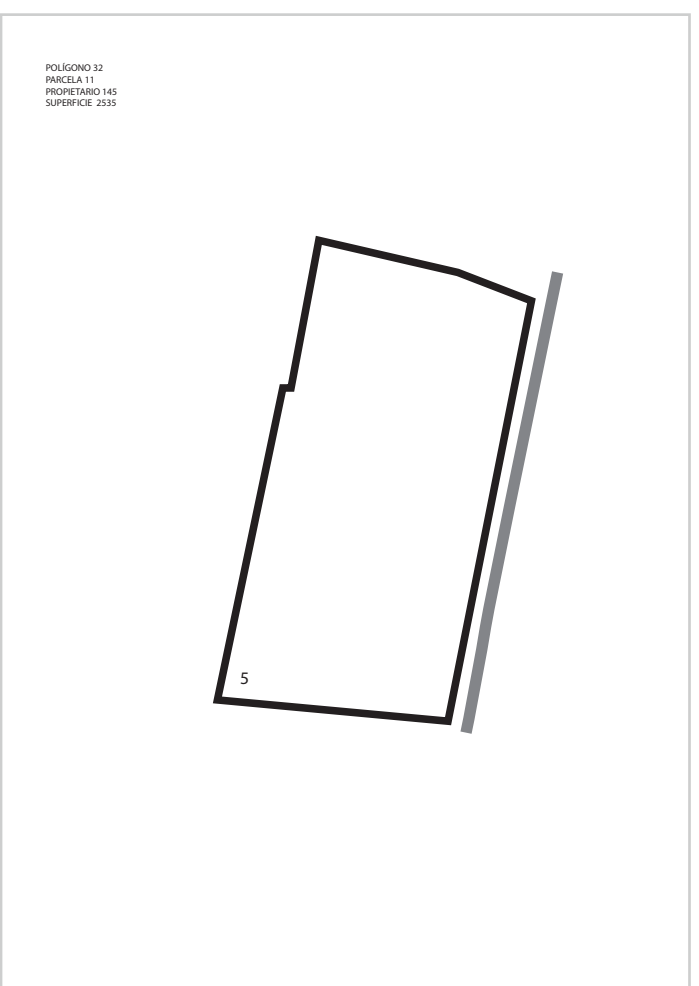
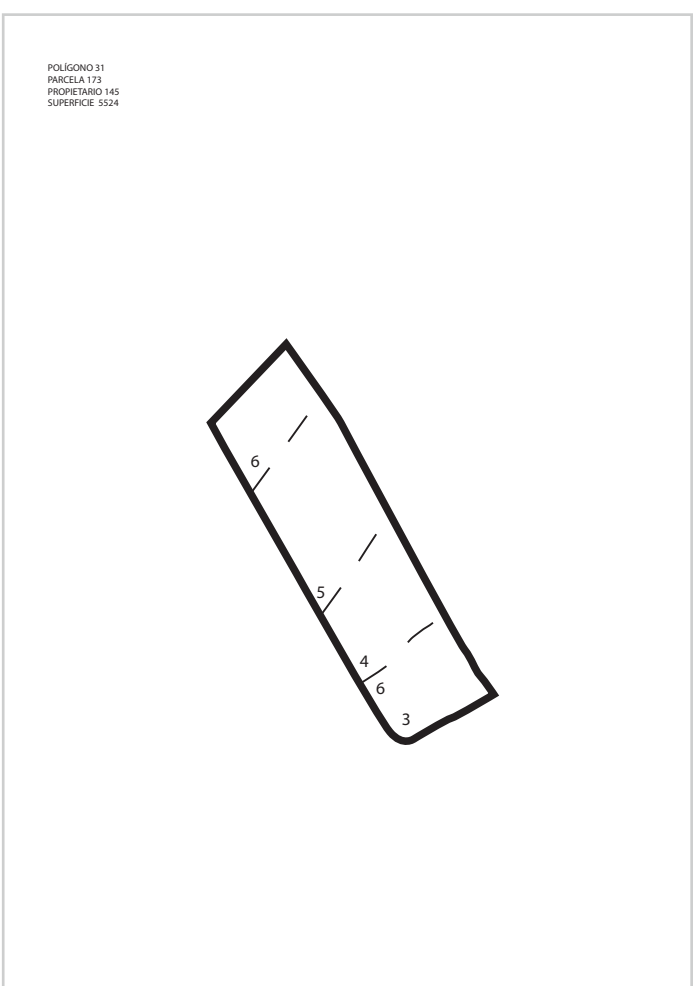
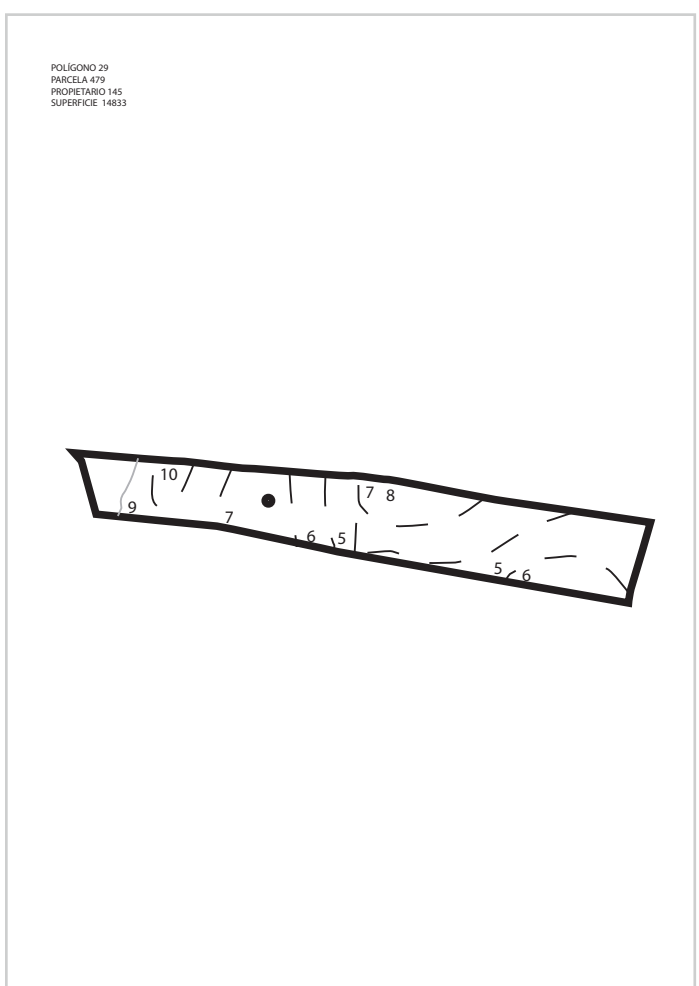
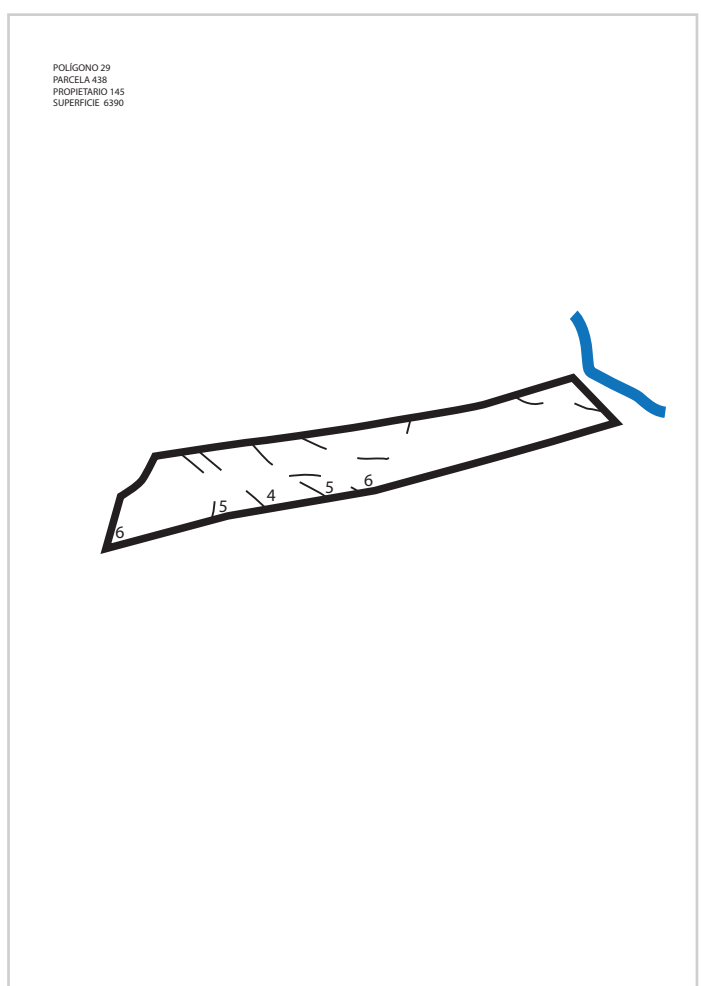
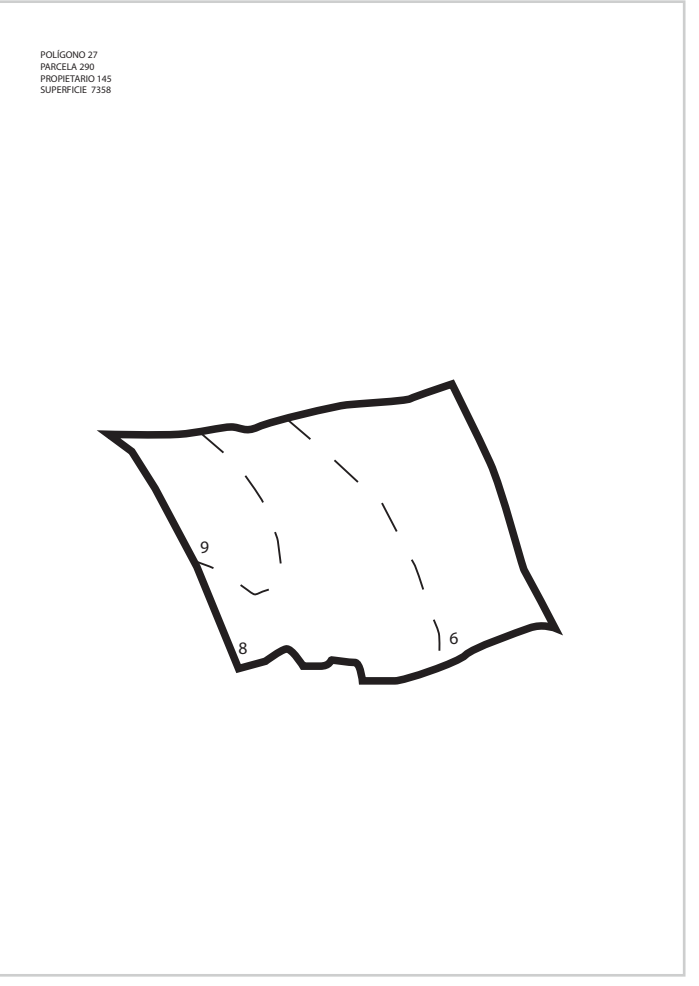
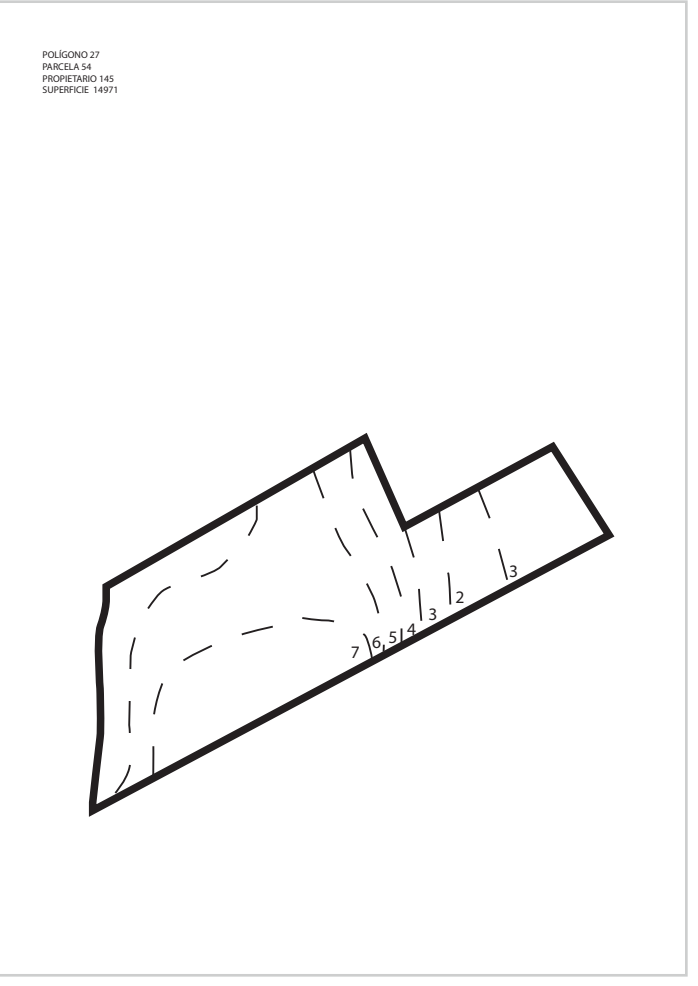
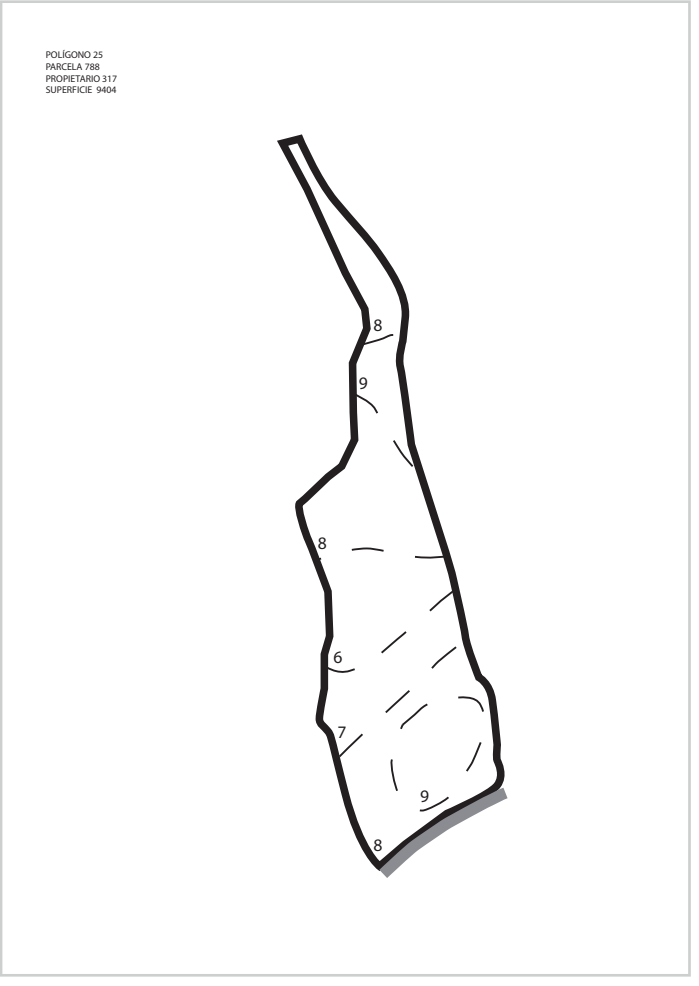
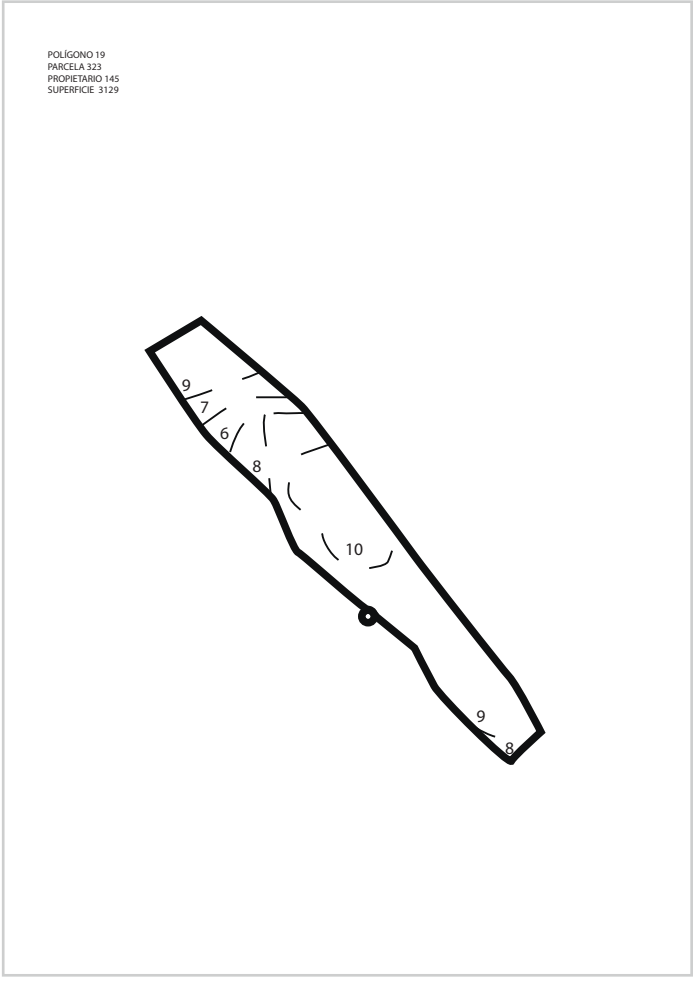
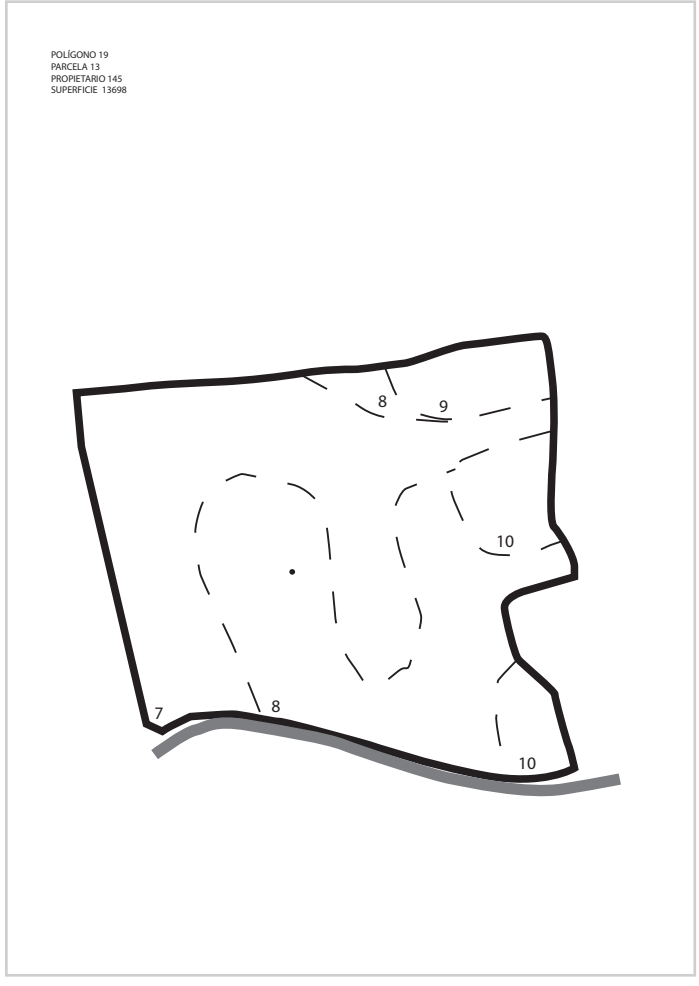
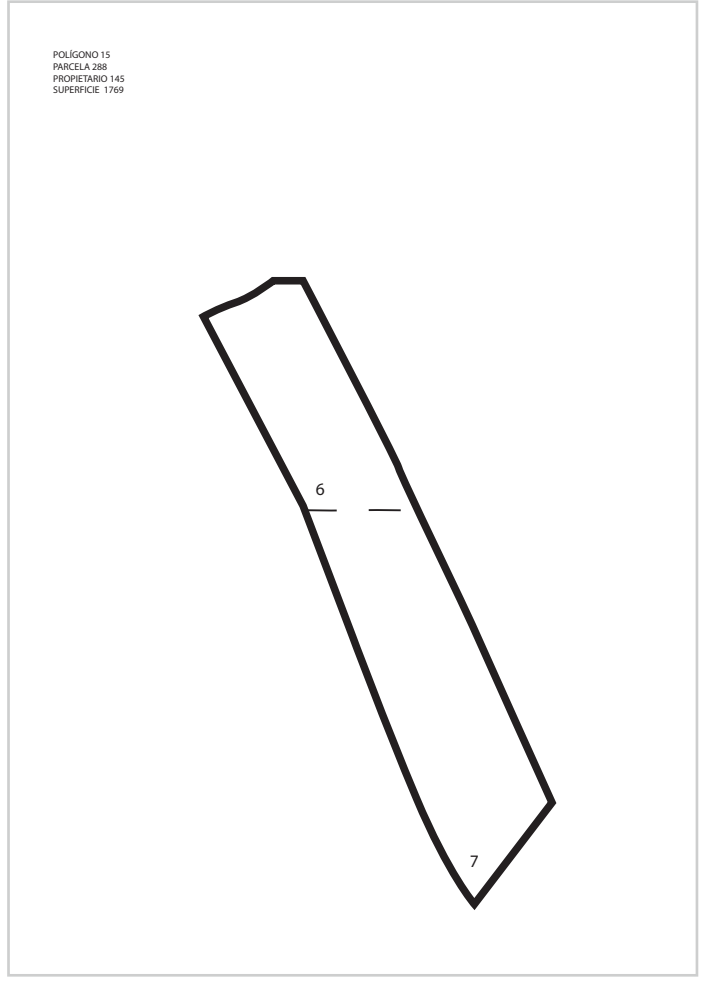
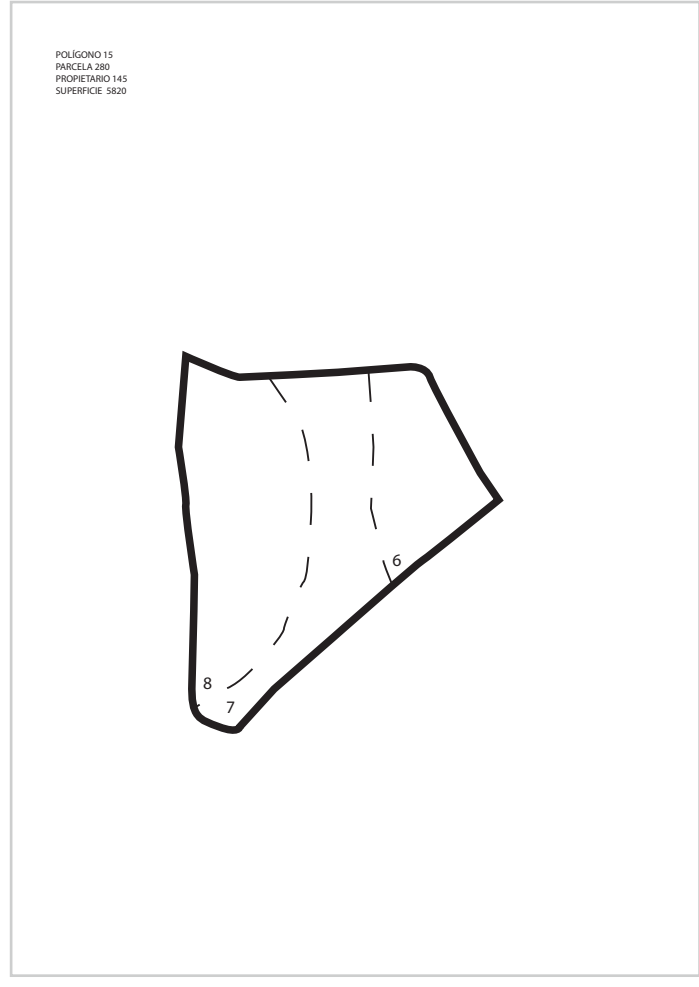
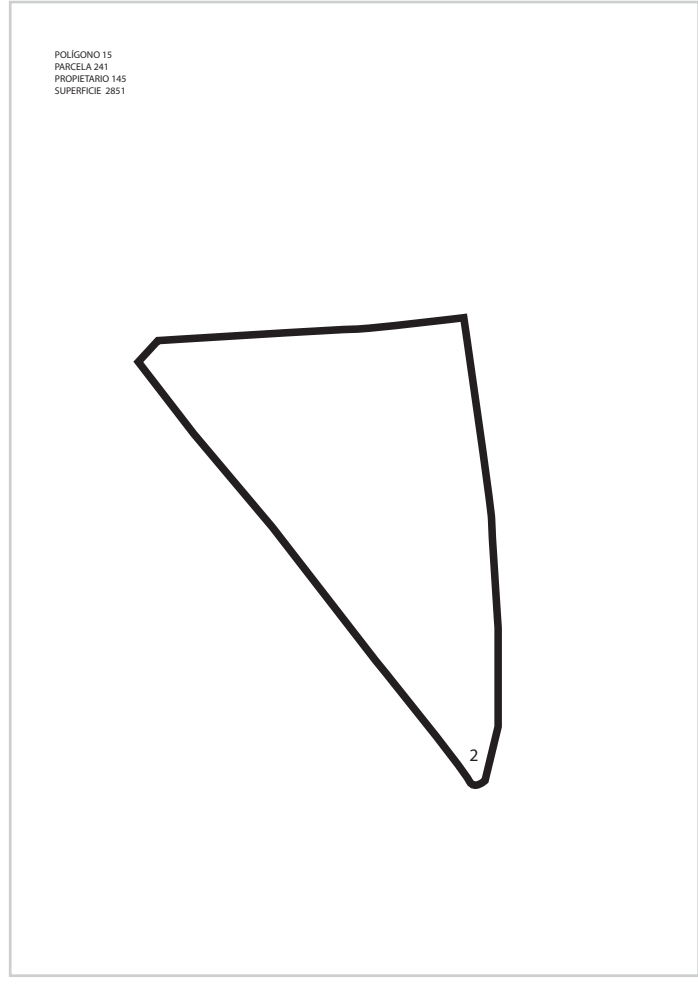
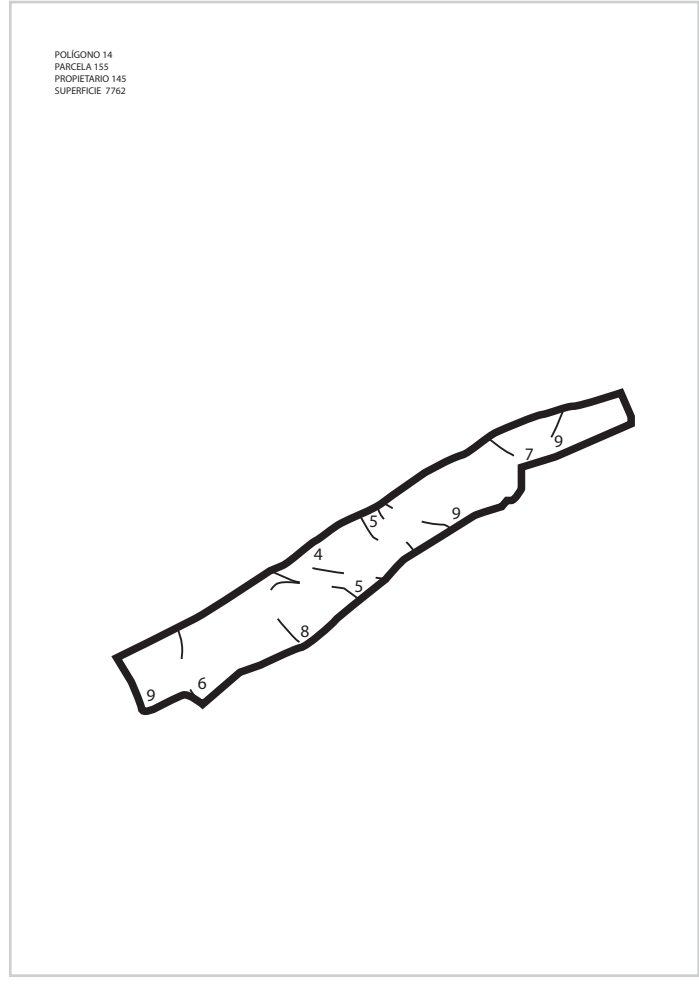
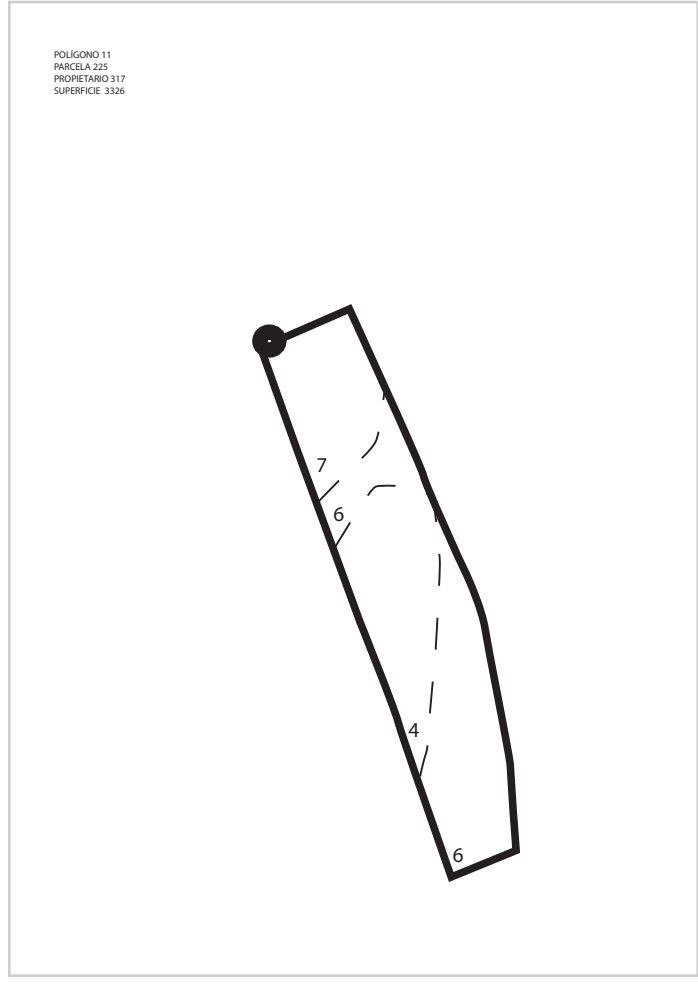
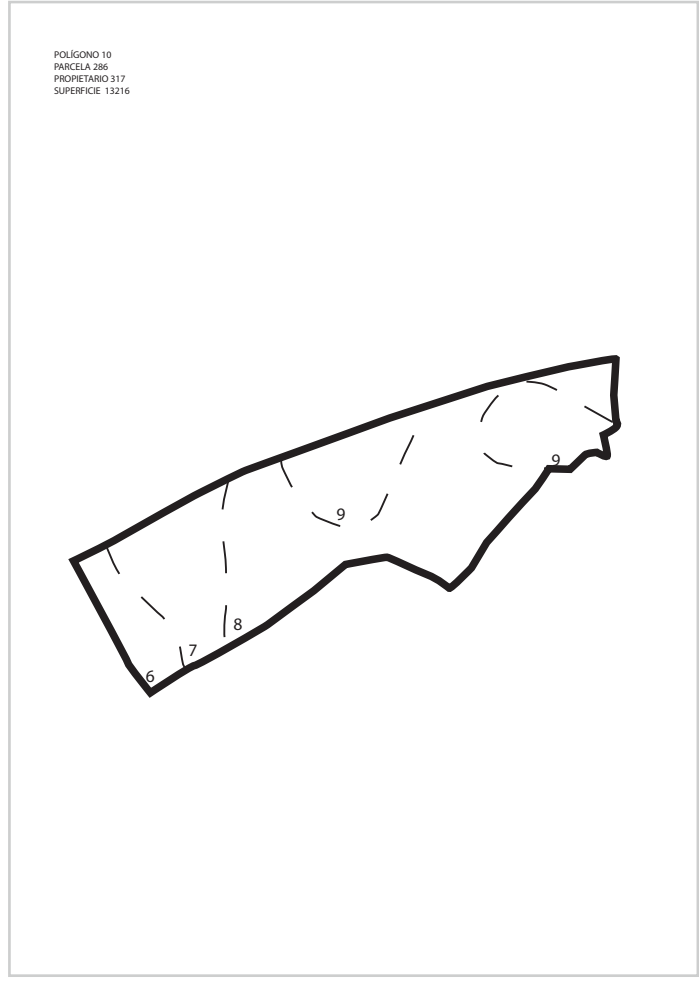
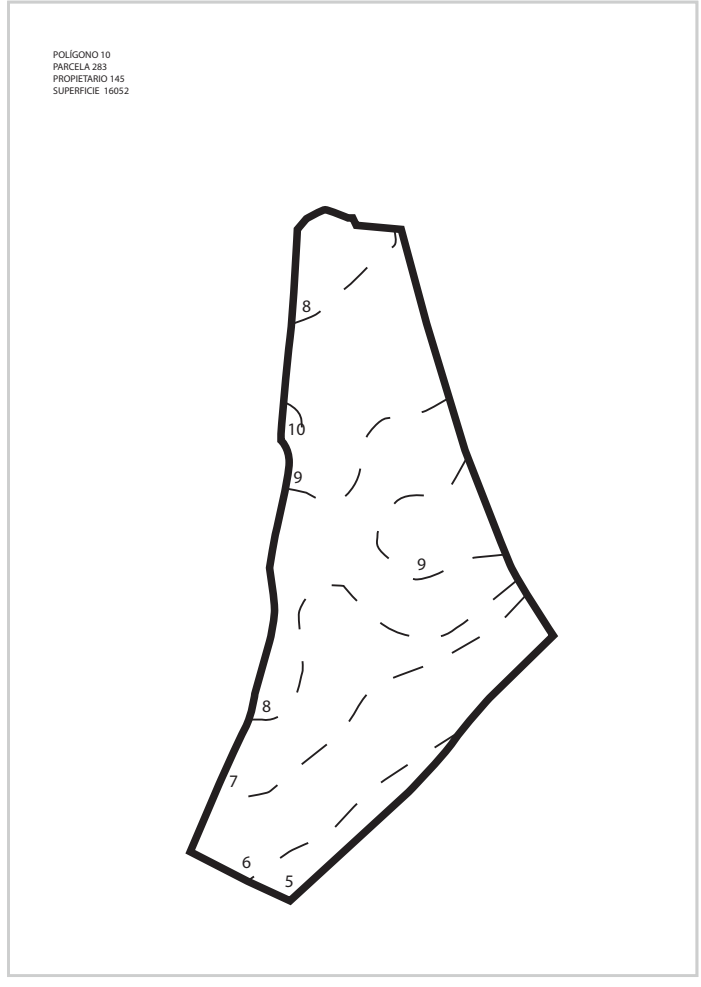
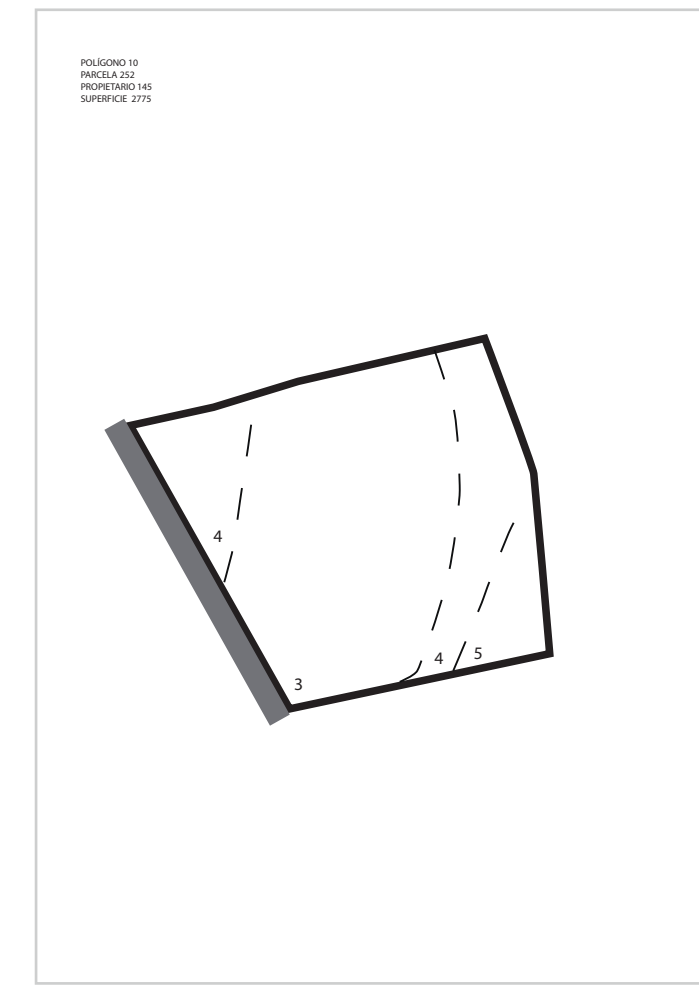
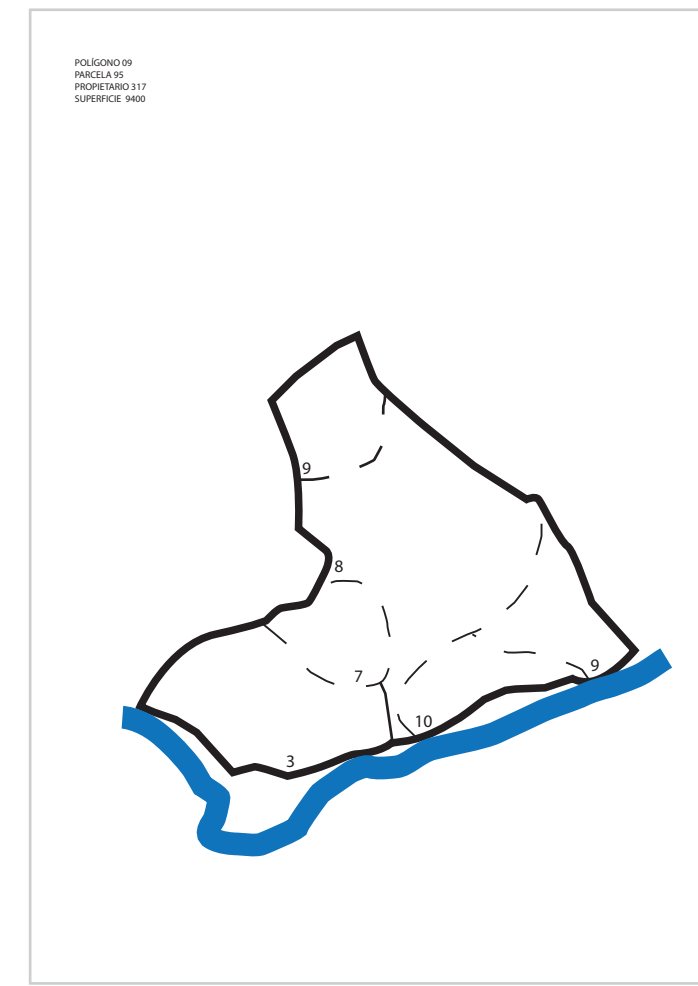
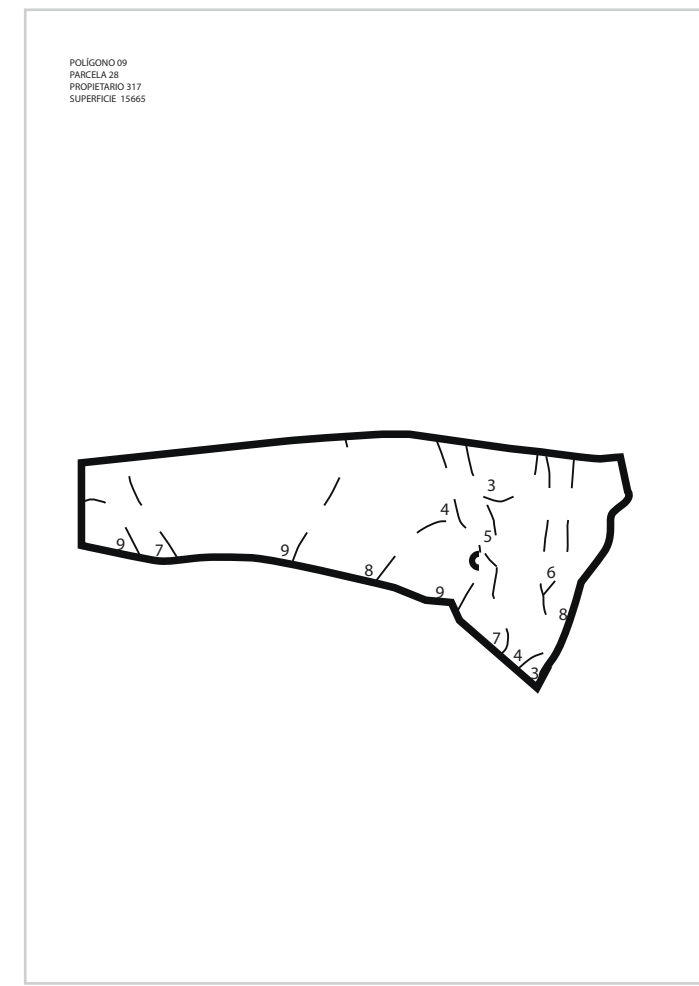
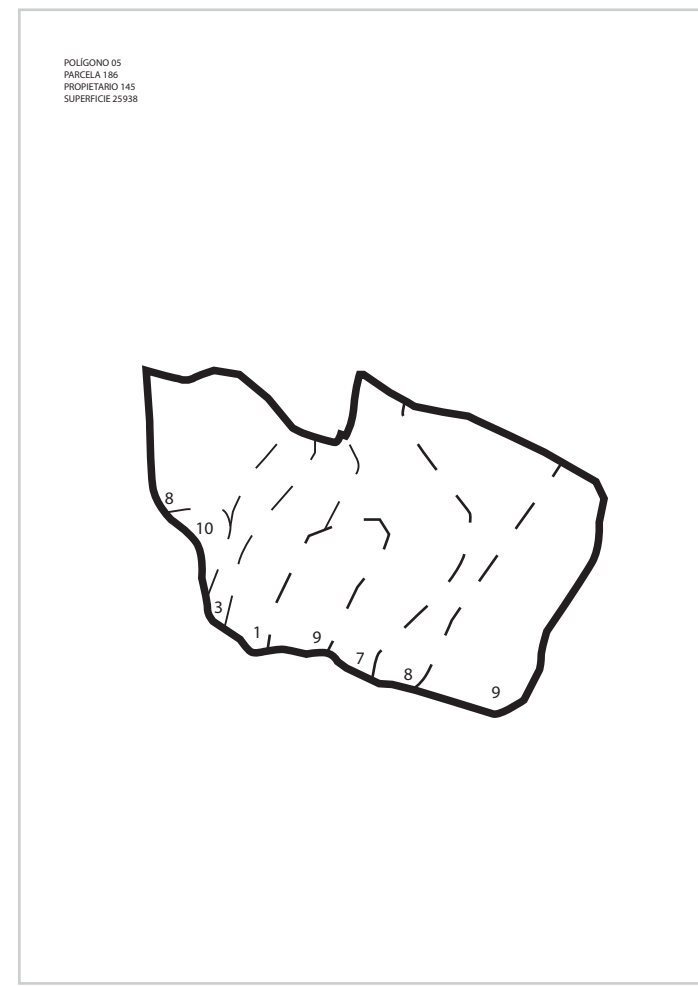
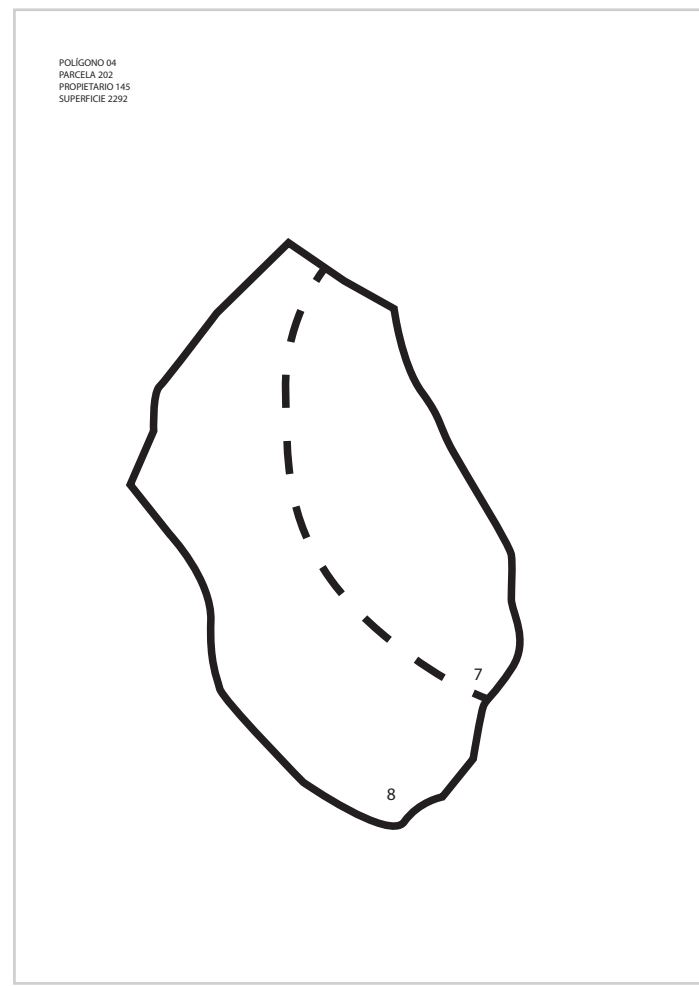
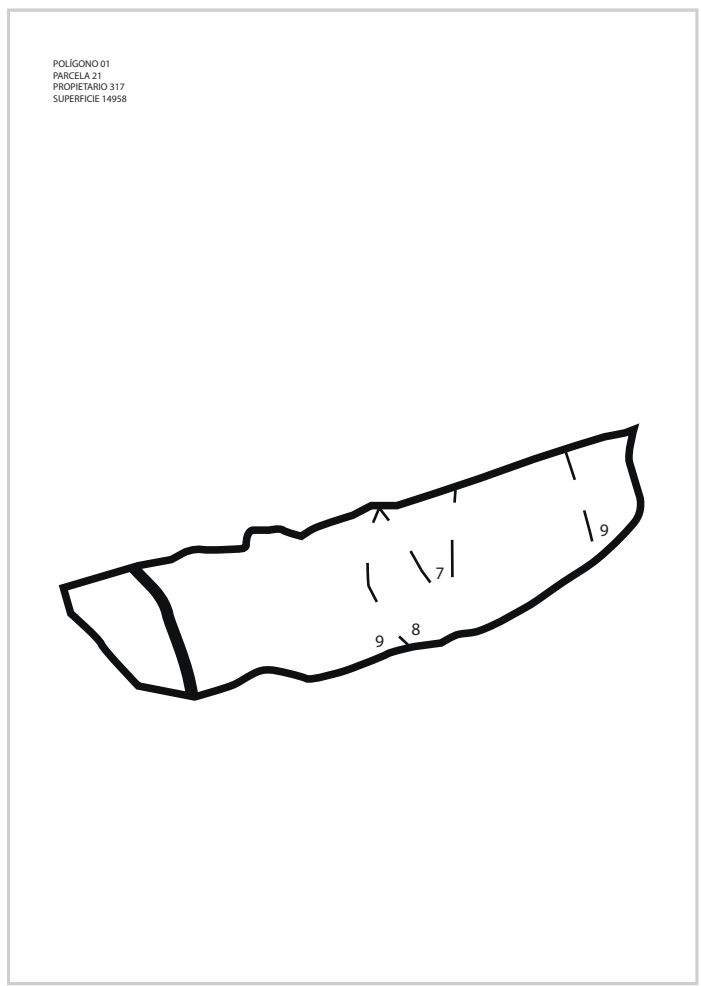

This artwork is a registration of all that life space in a digital age where all data is recorded. I want to keep the traces of my family experiences in those land properties and I want to make it evident for future generations.

A memory of what we were to understand how we are.  
The stone is an important element in the landscape of Sobradillo. People build and set boundaries with it. It belongs to another time, detached from human time, it's more eternal.

The stone is like witness of the passing of time that gives shape to space.

## NEGATIVE

Mould of a stone of land property of Chiquero. White Plaster.

## POSITIVE

Reproduction of a stone with a map of land properties. Black Refractory Clay fire 1140°















## LIBROS

Acaso, María. (2006). El lenguaje visual. Barcelona: Paidóns Ibérica.  
Albers, J. (2010). Interacción del color. Madrid: Alianza Forma  
Arnheim, R. (2002). Arte y percepción visual. Madrid: Alianza Editorial  
Barthes, R. (1989). La Cámara Lúcida. Barcelona: Paidóns Ibérica  
BollNow, O. (1969). Hombre y Espacio. Barcelona: Editorial Labor  
Careri, F. (2002). Walkspaces. El andar como práctica estética. Barcelona: Gustavo Gili  
Dondis, A. (2011). La sintaxis de la imagen. Introducción al alfabeto visual. Barcelona: Gustavo Gili Diseño  
Galofaro, L. (2003). Artscapes. El arte como aproximación al paisaje contemporáneo. Barcelona: Gustavo Gili Diseño  
Gombrich, E. H. (2008). La historia del arte. Londres: Phaidon Press Limited.  
Hernández González, F (1999). Raíces de la Villa de Sobradillo. Salamanca: Ediciones de la Diputación Provincial.  
Hutchison, E. (2008). El dibujo en el proyecto del paisaje. Barcelona: Gustavo Gili  
Maderuelo, J. (2006). Medio siglo de arte. Últimas tendencias, 1955-2005. Madrid: Abada Editores  
Maderuelo, J. (2010). Pablo Palazuelo. El plano extendido. Madrid: Abada Editores  
Munari, B. (2002). Diseño y comunicación visual. Barcelona: Gustavo Gili  
Raquejo, T (1998). Land Art. San Sebastián: Nerea  
Raquejo, T (2010). Destrucción y construcción del territorio. Memoria de lugares españoles. Madrid: Editorial Complutense de Madrid  
Salinas de Frias, M. (1986). La organización tribal de los Vettones. Salamanca: Ediciones Universidad de Salamanca.

## CATÁLOGOS

CHRISTINE LÖHR. Esculturas, dibujos e instalaciones. Centro de arte y naturaleza. Fundación Beulas. Huesca. 2007

RICHARD LONG. Piedras. Ministerio de cultura / the british council. Madrid. 1986  
RICHARD LONG Walking and marking. National Galleries of Scotland. Edimburgo. 2007

PALAZUELO. Obra sobre papel (1987-93). Sala de Exposiciones Banco Zaragozano. Febrero/Marzo 1994.  
PALAZUELO. Catálogo de la Exposición Retrospectiva del Museo Nacional Reina Sofía 2005.

## PÁGINAS WEB

<http://mapof.tumblr.com/page/2>

Hamish Fulton (<http://www.hamish-fulton.com/>)  
Francis Alÿs (<http://www.francisalys.com/>)  
Kim Baranowski (<http://www.kimbaranowski.com/>)  
Debra Weisberg (<http://www.debraweisberg.com/work/sculpture/>)  
Matthew Picton (<http://matthewpicton.com/>)  
Andreas Nicolas Fischer (<http://anf.nu/>)  
Mercedes Fidanza (<http://mercedesfidanza.com/>)

Madrid, 2 de junio de 2013

Juanma González

[juanma@inquattro.com](mailto:juanma@inquattro.com)

[www.juanmagonzalez.com](http://www.juanmagonzalez.com)